

CONSTRUCTION SEQUENCE FOR SEDIMENT CONTROL

1. PLACE EROSION CONTROL BARRIER AROUND THE PERIMETER OF THE CONSTRUCTION AREA.
2. AFTER THE TREES ARE CLEARED, EXCAVATION AND GRADING WILL TAKE PLACE FOR THE ENTRANCE DRIVE AND THE BUILDING PAD.
3. TEMPORARY SWALES WILL BE CONSTRUCTED ALONG THE EDGES OF THE PROPOSED DRIVEWAYS AND PARKING AREAS TO DIVERT RUNOFF TO THE SEDIMENT BASINS.
4. EXCAVATION FOR THE BUILDING SLAB WILL BE DONE IN 300 FT. SECTIONS SO THAT ONLY 4 ACRES WILL BE UNDER EXCAVATION AT A TIME.
5. A CRUSHED STONE BASE FOR THE CONCRETE BUILDING SLAB WILL BE PLACED TO STABILIZE THE THE 300 FT SECTION BEFORE THE NEXT SECTION IS EXCAVATED.
6. ONCE THE FOUNDATION STONE IS COMPLETED, THE PARKING LOTS AND DRIVEWAYS WILL BE GRADED THE UTILITIES ARE CONSTRUCTED AND A BASE COAT OF BITUMINOUS CONCRETE WILL BE PLACED, AND AT THE SAME TIME THE BUILDING SLAB WILL BE CONSTRUCTED.
7. ALL DISTURBED AREAS SHALL BE SEEDED TO PREVENT EROSION AS NOTED IN THE SWPPP.
8. THE BUILDING CONSTRUCTION TAKES PLACE.
9. ONCE CONSTRUCTION IS COMPLETE AND THE SITE HAS BEEN APPROVED BY THE LOCAL AUTHORITIES, THE EROSION CONTROL BARRIERS SHALL BE REMOVED.

NOTE:
UNDERGROUND UTILITY LOCATIONS ARE
NOT GUARANTEED.

IT SHALL BE THE RESPONSIBILITY OF THE
CONTRACTOR TO VERIFY LOCATIONS AND
ELEVATIONS OF EXISTING UTILITIES PRIOR
TO COMMENCEMENT OF ANY CONSTRUCTION

DIGSAFE IS TO BE NOTIFIED 72 BUSINESS
HOURS IN ADVANCE OF CONSTRUCTION.
CALL DIGSAFE AT 811



NOTE:
SEE SHEET 33 AND 34 OF 37 OF THE APPROVED SITE PLANS FOR
555 HOPPING BROOK ROAD, DATED, NOVEMBER 16, 2019 FOR THE
STORMWATER POLLUTION PREVENTION PLAN AND DETAILS.

ALL RIGHTS RESERVED

ENGINEERING DESIGN CONSULTANTS, INC. SHALL NOT BE
RESPONSIBLE FOR CONSTRUCTION MEANS, METHODS,
TECHNIQUES, OR PROCEDURES UTILIZED BY THE
CONTRACTOR, NOR FOR THE SAFETY OF PUBLIC OR
CONTRACTORS EMPLOYEES; OR FOR THE FAILURE OF THE
CONTRACTOR TO CARRY OUT THE WORK IN ACCORDANCE
WITH THE CONTRACT DOCUMENTS.

ENGINEERING DESIGN CONSULTANTS, INC.'S LIABILITY FOR
THIS PLAN IS LIMITED TO THE EXTENT OF ITS FEE LESS
THIRD PARTY COSTS.

DRWN BY: WML
CHKD BY: PSB
APPRO BY: PSB

REVISIONS:
REV 1 DATE 3/2/20 DESCRIPTION PEER REVIEW COMMENTS
REV 2 DATE 2/5/20 DESCRIPTION PEER REVIEW COMMENTS
REV 3 DATE 11/16/19 DESCRIPTION PEER REVIEW COMMENTS

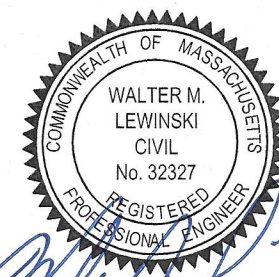

PREPARED BY:



Engineering Design Consultants, Inc.
32 Turnpike Road
Southborough, Massachusetts
ph: (508) 480-0225 fax: (800) 832-5781

PROJECT:

555 HOPPING BROOK ROAD
HOLLISTON, MASSACHUSETTS
(MIDDLESEX COUNTY)

TITLE:

EROSION CONTROL PLAN
555 HOPPING BROOK ROAD
HOLLISTON, MASSACHUSETTS

OWNER/APPLICANT:

CRG INTEGRATED REAL ESTATE SOLUTIONS
200 Barr Harbor Drive
Conshohocken, PA 19248

FILE NO: 3663 SWPPP-3
SWPPP 3
DATE: OCT. 22, 2020
DEFINITIVE PLAN NO: 2 OF 2
2

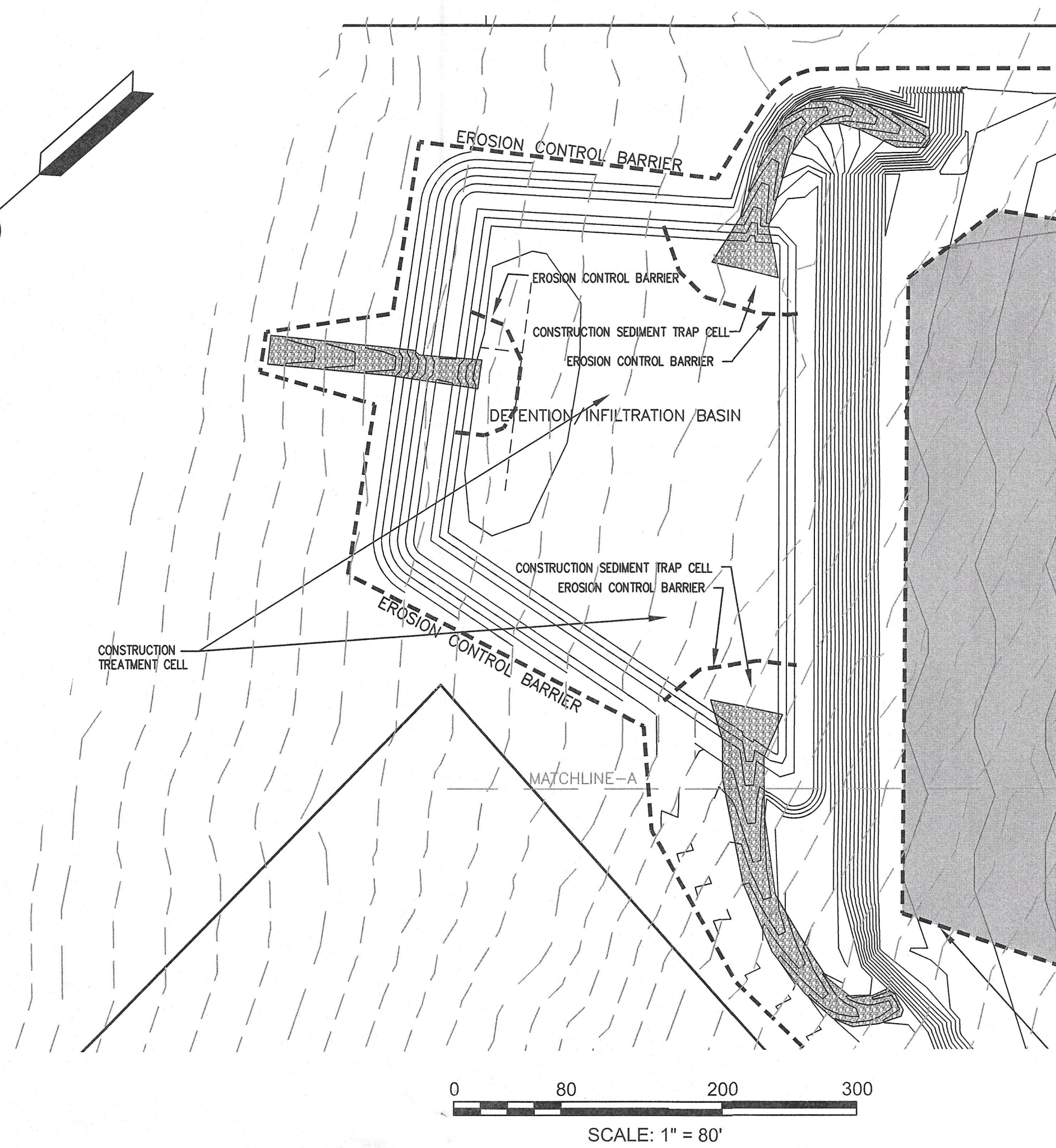

CONSTRUCTION SEQUENCE FOR SEDIMENT CONTROL

1. PLACE EROSION CONTROL BARRIER ON DOWN SIDE OF DETENTION BASIN.
2. EXCAVATE TO GRADE AND CONSTRUCT THE OUTLET CONTROL STRUCTURE.
3. STABILIZE AND SEED THE BASIN
4. CONSTRUCT THE UPPER TWO RIPRAP DRAINAGE SWALES AND AT THE SAME TIME PLACE EROSION CONTROL BARRIER AROUND THE DOWNHILL SLOPE OF THE SWALES AND AROUND THE OUTLET TO THE BASIN AS INDICATED ON THE PLAN.
5. DURING CONSTRUCTION OF THE PROJECT, THE SEDIMENTATION BASIN SHALL BE CHECKED AT REGULAR INTERVALS AS NOTED IN THE SWPPP, AND SEDIMENT SHALL BE REMOVED AS NECESSARY.

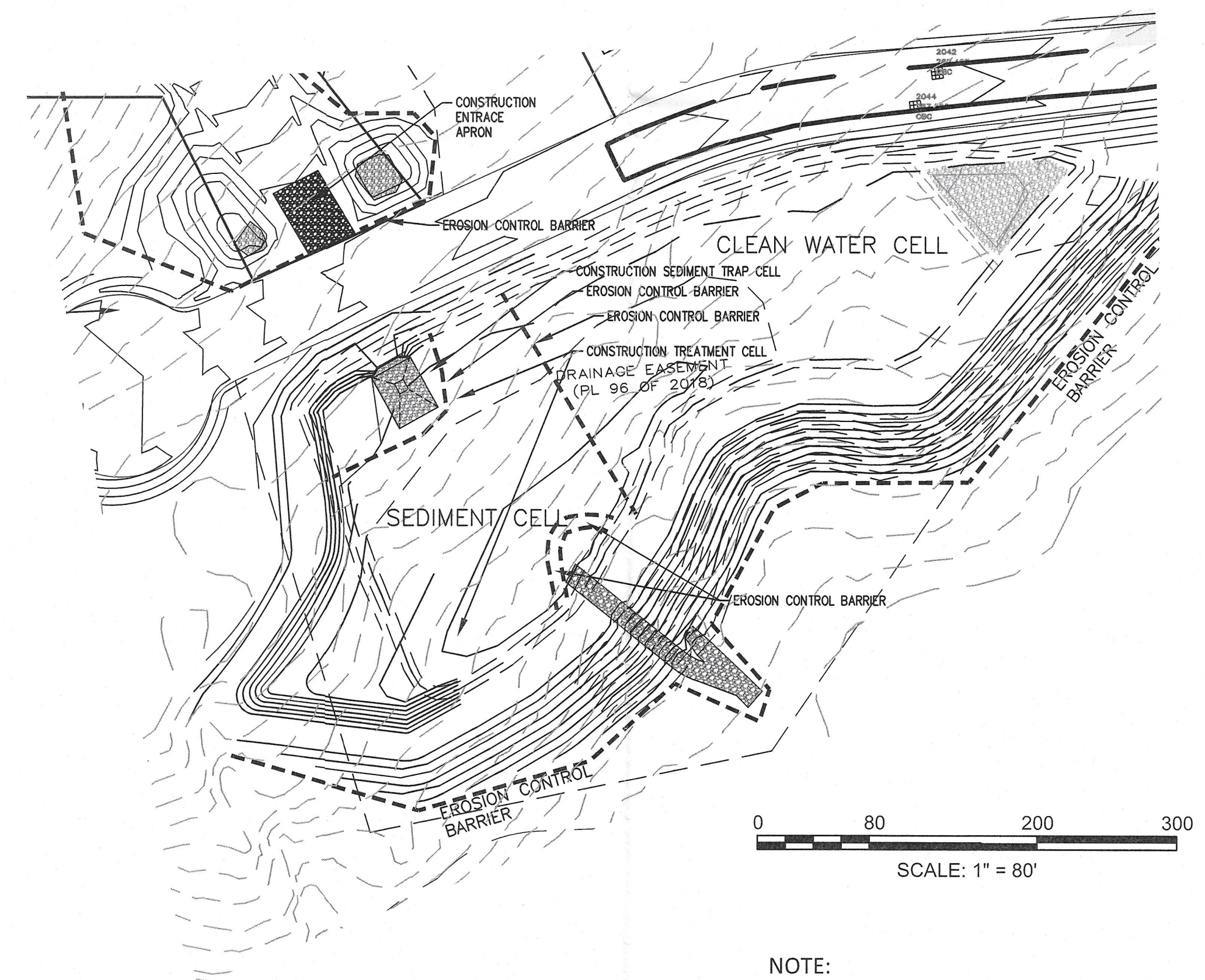

CONSTRUCTION SEQUENCE FOR SEDIMENT CONTROL

1. PLACE EROSION CONTROL BARRIER ON DOWN SIDE OF DETENTION BASIN.
2. EXCAVATE TO GRADE
3. STABILIZE AND SEED THE BASIN
4. CONSTRUCT THE UPPER TWO SMALLER BASINS AND CROSS CULVERTS AND PLACE EROSION CONTROL BARRIER AROUND THE BASINS AND AT THE SAME TIME PLACE EROSION CONTROL BARRIER AROUND THE OUTLETS AND AROUND THE OUTLET TO THE BASIN AS WELL AS THE DIVISION BETWEEN THE CLEAN WATER CELL AND THE SEDIMENT CELL AS INDICATED ON THE PLAN.
5. CONSTRUCT THE CONSTRUCTION ENTRANCE APRON.
6. DURING CONSTRUCTION OF THE PROJECT, THE SEDIMENTATION BASIN SHALL BE CHECKED AT REGULAR INTERVALS AS NOTED IN THE SWPPP, AND SEDIMENT SHALL BE REMOVED AS NECESSARY.

NOTE:
UNDERGROUND UTILITY LOCATIONS ARE
NOT GUARANTEED.

IT SHALL BE THE RESPONSIBILITY OF THE
CONTRACTOR TO VERIFY LOCATIONS AND
ELEVATIONS OF EXISTING UTILITIES PRIOR
TO COMMENCEMENT OF ANY CONSTRUCTION

DIGSAFE IS TO BE NOTIFIED 72 BUSINESS
HOURS IN ADVANCE OF CONSTRUCTION.
CALL DIGSAFE AT 811



ENGINEERING DESIGN CONSULTANTS, INC. SHALL NOT BE
RESPONSIBLE FOR CONSTRUCTION MEANS, METHODS,
TECHNIQUES, OR PROCEDURES UTILIZED BY THE
CONTRACTOR, NOR FOR THE SAFETY OF PUBLIC OR
CONTRACTORS EMPLOYEES; OR FOR THE FAILURE OF THE
CONTRACTOR TO CARRY OUT THE WORK IN ACCORDANCE
WITH THE CONTRACT DOCUMENTS.

ENGINEERING DESIGN CONSULTANTS, INC.'S LIABILITY FOR
THIS PLAN IS LIMITED TO THE EXTENT OF ITS FEE LESS
THIRD PARTY COSTS.

DRWN BY: WML
CHKD BY: PSB
APPRO BY: PSB

REVISIONS
0 10/22/20 10/22/20
REV # DATE DESCRIPTION

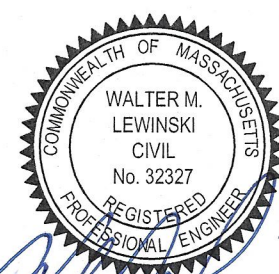

Engineering Design Consultants, Inc.
32 Tumpike Road
Southborough, Massachusetts
ph: (508) 480-0225 fax: (800) 832-5781

PROJECT:

555 HOPPING BROOK ROAD
HOLLISTON, MASSACHUSETTS
(MIDDLESEX COUNTY)

FILE:

EROSION CONTROL PLAN
555 HOPPING BROOK ROAD
HOLLISTON, MASSACHUSETTS

OWNER/APPLICANT:

CRG INTEGRATED REAL ESTATE SOLUTIONS
200 Barr Harbor Drive
Conshohocken, PA 19248

FILE NO: 3663 SWPPP-3
SWPPP 2
DATE: OCT. 22, 2020
DEFINITE PLAN NO: 1 of 2
1